



# INSTALLATION INSTRUCTIONS: VICTORY TOURING HI-OUTPUT SLIP-ONS PART# 68005/68505

Congratulations, you have purchased the finest exhaust system available for your motorcycle. Your Vance & Hines exhaust is designed and crafted for performance, quality, and style. Please follow the instructions below. Check the exhaust system for missing or damaged parts and if you need any assistance please contact our technical support line (562) 921-7461.

## PARTS LIST

ITEM NO.	PART NUMBER	DESCRIPTION	QTY.
1	V510RC/ V505RP	H.O. SLIP-ON, RIGHT SIDE	1
2	V511RC/ V506RP	H.O. SLIP-ON, LEFT SIDE	1
3	A240HW	FHS 5/16-18 X .625inL	4

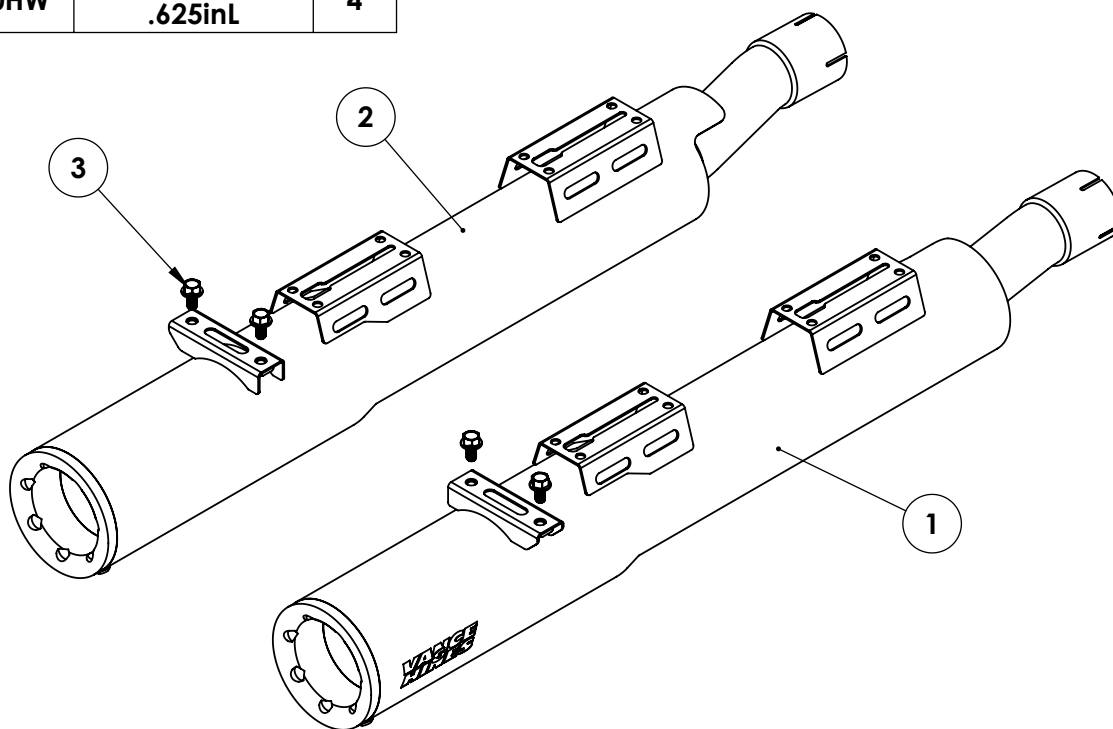

## TOOLS REQUIRED



COMBINATION  
WRENCH: 9/16, 1/2",  
13mm

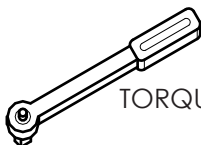

TORQUE WRENCH: In./Lbs.

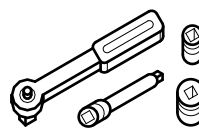

3/8" RATCHET  
SOCKETS: 9/16",  
1/2", 13mm

## STOCK EXHAUST SYSTEM REMOVAL

1. Remove both saddlebags by using quick release pins inside the bags.
2. Slide rubber pads from top of mufflers and set aside, these will be reused.
3. Carefully remove both heat shields by detaching hose clamps, these parts will be reused.
4. On both sides, loosen Torca band clamps to remove muffler.
5. Remove four M8 x 1.25mm bolts that mount the muffler to the bike and slide muffler off of head pipe. **NOTE:** Lubricant may be necessary to remove muffler.

## VANCE & HINES EXHAUST INSTALLATION

1. Install rubber pads from stock muffler to V&H's mufflers.
2. Remove Torca clamps from stock muffler and install onto new V&H's mufflers.
3. Slip the muffler over the stock head pipes and mount the muffler to the support brackets using two 5/16-18 flange bolts (supplied) and tighten. **NOTE:** There are different mufflers, the logos face outwards.
4. Reinstall heatshields to each side.
5. On left muffler, align S-bend mid pipe and muffler to insure correct fitting. (See **Figure 1**)
6. Tighten Torca band clamps on both sides. (Torque specification 40-45 ft/lbs.)
7. Reinstall saddlebags using quick release pins. **NOTE:** Check to see if bags are resting on rubber muffler brackets mounts.
8. Be sure to tighten all hardware before starting your motorcycle.
9. After test ride let pipes cool down and re-torque muffler band clamps.

## EXHAUST CARE (CHROME)

1. When installing a new set of chrome pipes, make sure your hands are clean and free of oil. After installation, thoroughly clean pipe with a soft cloth and cleaning solvent that will leave no residue ( chrome wax/polish, glass cleaner, alcohol, ammonia, etc...) before starting the motorcycle.
2. Avoid long periods of idling as this can cause discoloration.
3. Intake leaks can cause the engine to run lean and overheat, this could lead to discoloration.

## EXHAUST CARE (BLACK)

1. When installing a new set of black pipes, make sure your hands are clean and free of oil. After installation, thoroughly clean pipe with warm soapy water and a soft cloth. Dry with a clean towel to remove any residue before starting the motorcycle. Do NOT use anything abrasive to clean the pipes.
2. Avoid long periods of idling as this can cause discoloration.
3. Intake leaks can cause the engine to run lean and overheat, this could lead to discoloration.
4. Make sure there are no exhaust leaks at the junction of the exhaust pipes and the cylinder head. We recommend replacing gaskets if they are worn.

**FIGURE 1.** (LEFT SIDE OF BIKE, BELOW SEAT).

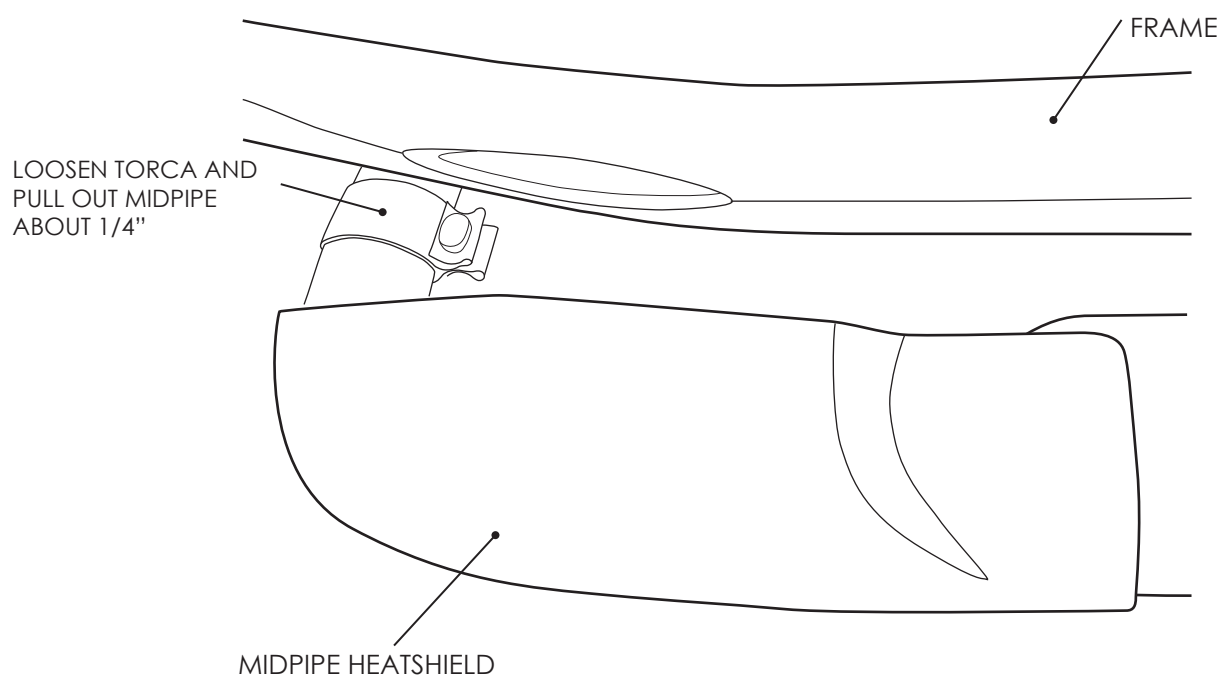

**Emissions Notice:**

In California, in order to meet Air Resources Board emissions requirements, certain aftermarket part applications have been identified as replacements, and others have received ARB Executive Orders. All other emissions related aftermarket parts are for competition use only. A list of replacement parts and EO parts, and corresponding fitment is provided at [vanceandhines.com/california](http://vanceandhines.com/california).

**Warranty:**

All Vance & Hines products are warranted against defects in material and workmanship for a period of 90 days. This warranty does not cover discoloration or rust. This warranty shall be limited to the repair or replacement of the product, which may be proven defective under normal use. Vance & Hines will not warranty any system that has been abused, misused, improperly installed or modified.

Dealers or distributors are not authorized to make dispositions binding upon Vance & Hines. Vance & Hines will not be responsible for any labor charges incurred in removing or replacing any system under warranty. A return authorization number and a copy of the original purchase invoice must accompany all returns. Parts returned without a return authorization may be refused.

13861 ROSECRANS AVENUE / SANTA FE SPRINGS, CA 90670  
SALES: (562) 921-5388  
TECHNICAL: (562) 926-5291  
FAX: (562) 802-0110