

Congratulations, you have purchased the finest exhaust product for your motorcycle. This Vance & Hines exhaust product is type-approved for highway use in the European Union when installed on Harley-Davidson. Please follow the installation instructions below and if you have any questions, please call our technical support line at (562) 926-5291.

Attention installer (if other than owner), please forward this instruction sheet to the owner of this product. These instructions contain valuable information to the end user.

PARTS LIST

ITEM NO.	DESCRIPTION	QTY.
1	REAR CYLINDER MUFFLER	1
2	FRONT CYLINDER MUFFLER	1
3	STANDOFF SPACER	1
4	3/8-16 X 4.75" SOCKET HEAD CAP SCREW	1

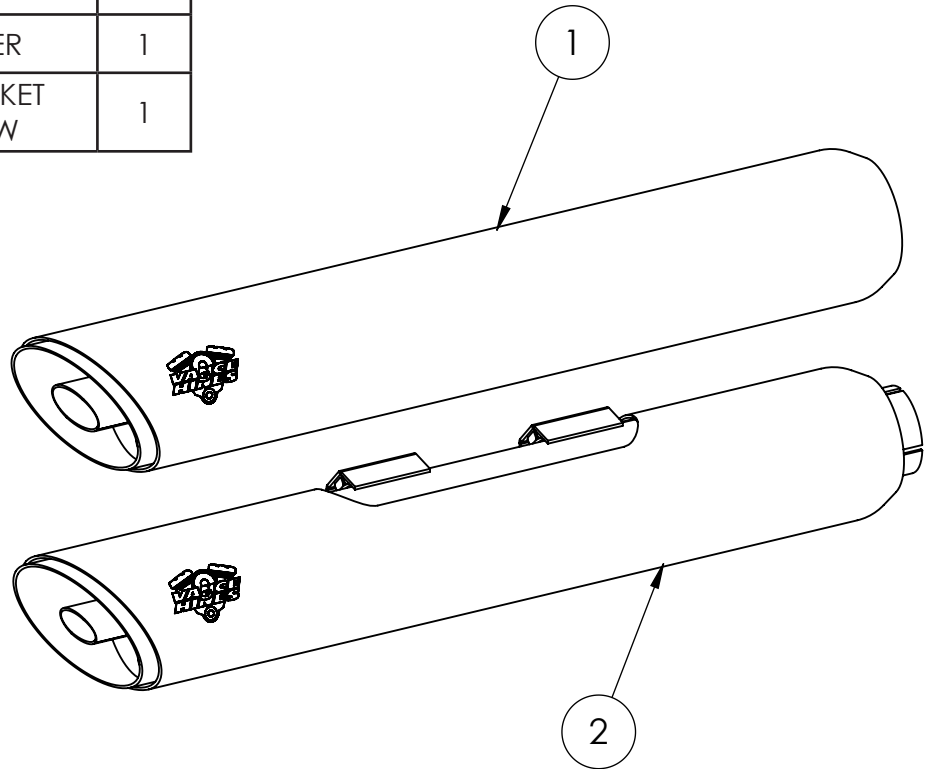

HARDWARE

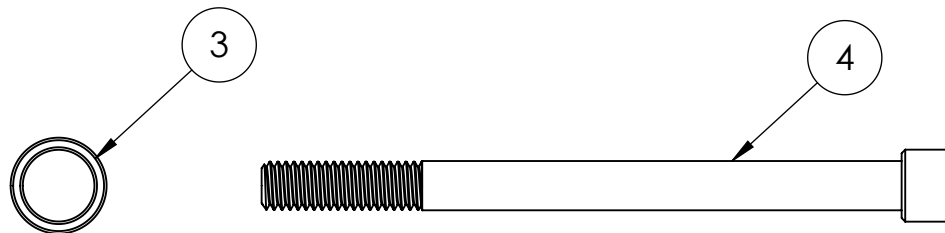

*NOT TO SCALE

TOOLS REQUIRED

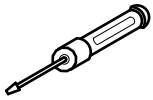

FLAT BLADE
SCREWDRIVER

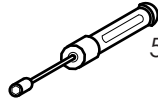

5/16 NUT DRIVER

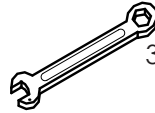

3/8" WRENCH

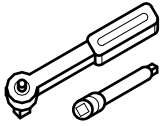

RATCHET: 3/8" DRIVE
SOCKETS: 9/16", 1/2", 3/8"
9" EXTENSION



Allen Wrench: 5/16"
Torx Wrench: T50

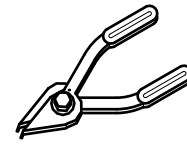

Snap Ring Pliers

STOCK EXHAUST SYSTEM REMOVAL

1. Loosen the heat shield clamps on both front and rear exhaust pipes.
2. Loosen the clamps holding the mufflers onto the head pipes.
3. Loosen, but do not remove, the exhaust flange nuts located at the cylinder head.
4. Remove the hex head bolt holding the muffler to the muffler support bracket. Retain the bolt for later use.
5. Carefully remove muffler by sliding them off each head pipe. **NOTE:** Assistance may be required.
6. Remove the right side passenger foot peg by removing the circlip that is holding the foot peg in place.
7. Remove the bolt holding the passenger foot peg mount; this bolt will not be reused.
8. Replace the passenger foot peg mount with the supplied bolt(4) and use the spacer(3) at the other end of the foot peg mount. This spacer will allow appropriate clearance for the new mufflers.

VANCE & HINES EXHAUST INSTALLATION

1. Remove the muffler assemblies from their protective packaging.
2. Slide stock exhaust clamps onto the inlet of each muffler body. **NOTE:** Orient the clamp in a way that you can access the nut during installation.
3. Slide mufflers onto the head pipes.
4. Using stock hardware, attach the mufflers to the muffler support bracket. **NOTE:** Leave them loose at this time.
5. Align mufflers so they sit level. Tighten the muffler mounting bolts.
6. Tighten exhaust flange nuts on both the front and rear cylinders.
7. Tighten the clamp holding the muffler onto the head pipe. Check orientation with stock head pipe heat shield to insure that you do not have interference between the clamp and stock heat shield.
8. Loosen heat shield hose clamps and do a final alignment of heat shields and retighten the heat shield hose clamps.
9. Check for clearance between all exhaust system components and accessories prone to heat damage.
10. Be sure to check and tighten all hardware before starting your motorcycle.

EXHAUST CARE

1. When installing a new set of chrome pipes, make sure your hands are clean and free of oil. After installation, thoroughly clean pipes with a soft cloth and cleaning solvent that will leave no residue (chrome wax/polish, glass cleaner, alcohol, ammonia, etc.) before starting the motorcycle.
2. Avoid long periods of idling as this can cause discoloration.
3. Intake leaks can cause the engine to run lean and overheat, this could lead to discoloration.
4. Make sure there are no exhaust leaks at the junction of the exhaust pipes and the cylinder head. We recommend replacing gaskets if they are worn.

EXHAUST CARE (BLACK)

1. When installing a new set of black pipes, make sure your hands are clean and free of oil. After installation, thoroughly clean pipes with warm soapy water and a soft cloth. Dry with a clean towel to remove any residue before starting the motorcycle. Do NOT use anything abrasive to clean the pipes.
2. Avoid long periods of idling as this can cause discoloration.
3. Intake leaks can cause the engine to run lean and overheat, this could lead to discoloration.
4. Make sure there are no exhaust leaks at the junction of the exhaust pipes and the cylinder head. We recommend replacing gaskets if they are worn.

Emissions Notice:

In California, in order to meet Air Resources Board emissions requirements, certain aftermarket part applications have been identified as replacements, and others have received ARB Executive Orders. All other emissions related aftermarket parts are for competition use only. A list of replacement parts and OE parts, and corresponding fitment is provided at vanceandhines.com/California.

Warranty:

All Vance & Hines products are warranted against defects in material and workmanship for a period of 90 days. This warranty does not cover discoloration or rust. This warranty shall be limited to the repair or replacement of the product, which may be proven defective under normal use. Vance & Hines will not warranty any system that has been abused, misused, improperly installed or modified.

Dealers or distributors are not authorized to make dispositions binding upon Vance & Hines. Vance & Hines will not be responsible for any labor charges incurred in removing or replacing any system under warranty. A return authorization number and a copy of the original purchase invoice must accompany all returns. Parts returned without a return authorization may be refused.

13861 ROSECRANS AVENUE / SANTA FE SPRINGS, CA 90670
SALES: (562) 921-5388
TECHNICAL: (562) 926-5291
FAX: (562) 802-0110