



MORE POWER : LESS NOISE



Congratulations, you have purchased the finest exhaust system for your motorcycle on the market. Your Vance & Hines exhaust system is designed and crafted for maximum performance, a perfect fit, a great sound and unbeatable style. Please follow the installation instructions below and if you have any questions, please call our technical support line at (562) 926-5291.

Attention installer (if other than owner), please forward this instruction sheet to the owner of this product. These instructions contain valuable information to the end user.

**TOOLS
REQUIRED**

- Flat blade screwdriver
- #3 Phillips Head
- 5/16" Nutdriver
- 1/2" & 14mm
7/8 or 22mm
Combination wrenches
- 3/16", 1/4" & 3/8"
Allen wrenches
- Snapping pliers
- 3/8" Ratchet &
extensions
1/2" Socket & 9/16,
5/8 and 15mm Deep
Socket

READ ALL INSTRUCTIONS BEFORE BEGINNING INSTALLATION

**STOCK EXHAUST
SYSTEM REMOVAL**

1. Remove seat to gain access to rear oxygen sensor connector. Unplug sensor and feed end of wire through frame to free it from motorcycle. NOTE: Pay attention to wire routing for re-installation.
2. For **2006 to 2011 Models** remove two bolts holding rectifier onto front of frame (near front tire). Open plastic cover to gain access to front oxygen sensor connector. Unplug sensor from harness and feed end of wire through to free it from motorcycle. For **2012, 2013 Models** the connector is located under the frame at the front of the motorcycle.
3. Loosen heat shield clamps on both the front and rear head pipes.
4. If equipped, remove front head pipe clamp carriage bolt.
5. Remove the bolt that attaches mufflers to the frame mounting bar.
6. Remove two cylinder exhaust port flange nuts from each head pipe, located at the cylinder head.
7. Remove the complete exhaust system and set aside (Assistance may be required).
8. Remove stock mounting bar and the studs in the transmission cover.
9. Position mounting bracket 767-P over mounting location to determine which bolts to remove (Figure 1).
10. Carefully remove the flanges and circlips from the stock exhaust system using snapping pliers. NOTE: Replace bent or damaged circlips.
11. Remove stock exhaust gaskets and replace them with the supplied exhaust gaskets.
12. If equipped, using a 7/8" or 22mm wrench (for 18mm sensors) or a 14mm wrench (for 12mm sensors), carefully remove the O2 sensors from the stock head pipes.

FIGURE 1

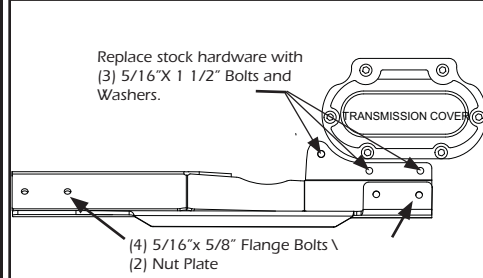

FIGURE 2

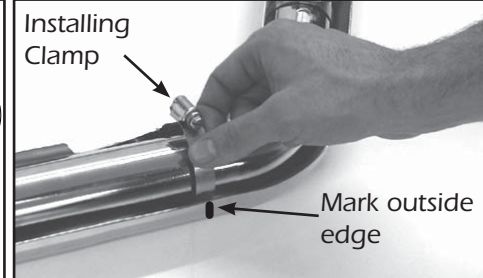

FIGURE 3

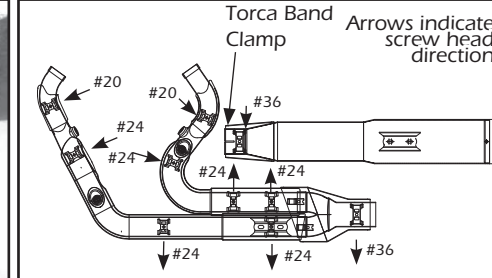

FIGURE 4

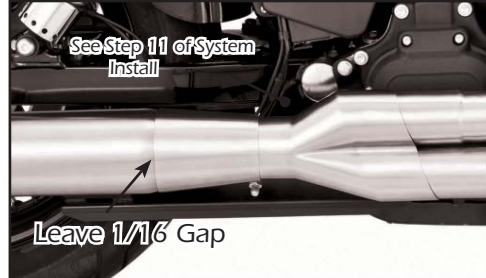

FIGURE 5

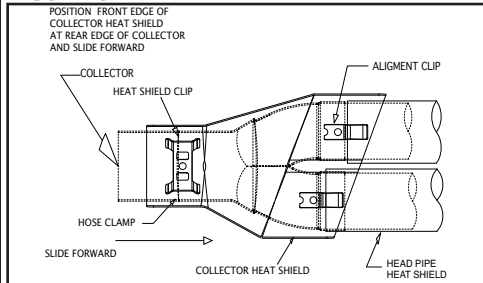

FIGURE 6

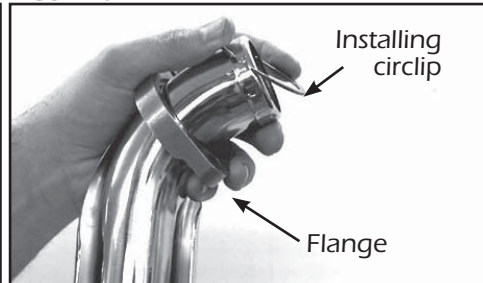
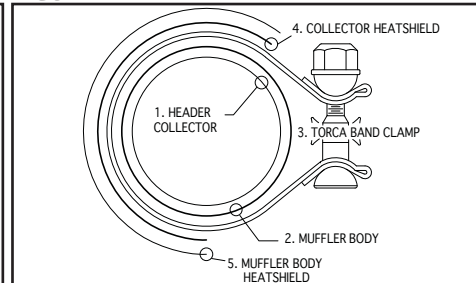

FIGURE 7



1. Attach mounting bracket 767-P to transmission using three 5/16" x 1 1/2" hex head bolts and washers and tighten to 12 - 15 ft/lb torque (Figure 1).
2. Remove header and heat shields from protective packaging. Place each heat shield on a non-abrasive surface such as a blanket or carpet. Using a felt tip pen, mark outside edge of each heat shield to show location of mounting clips that hose clamps will loop through (Figure 2).
3. Lay heat shields onto their respective head pipes. On the D691HB front 2-1/2" heat shield & D693HB Rear 2-1/2" heat shield, install the #24 hose clamps on the heat shield clips by feeding through the tail end of the clamp. Take note of clamp screw direction (Figure 3). On the D690HB front 2-1/8" heat shield & D692HB rear 2-1/8" heat shield, install #20 hose clamp into each heat shield clip. Screw heads must be accessible when the system is installed on the motorcycle for adjustment purposes. NOTE: Do not tighten the hose clamps at this time.
4. Apply a small amount of anti-seize compound to the threads of the O2 sensors removed from the stock head pipes and install them into the new head pipes. On 2012 / 2013 models, install O2 sensor with gray connector (short) in the front head pipe and the O2 sensor with the black connector (long) into the rear head pipe. Be careful not to get anti-seize on sensor tip, it may affect sensor function. NOTE: Make sure the O2 sensors are tight
5. Install exhaust port flanges and circlips (from stock system) onto head pipes (Figure 6).
6. Using stock flange nuts, carefully install header into exhaust ports, starting with the rear cylinder. Assistance may be required. NOTE: Do not tighten at this time.
7. Slide nut plate into tent bracket on main header (D690FB) and attach to bracket using (2) 5/16" x 3/4" flange head bolts NOTE: Do not tighten at this time.
8. Install Torca band clamp (Supplied) onto the end of the muffler body with the nut facing up (Figure 7).
9. Install the muffler body with Torca clamp onto the collector of the header assembly (D690FB). Slip the nut plate into the bracket welded to the muffler body and attach the muffler body to the 767-P bracket using two (2) 5/16" x 3/4" flange head bolts (Figure 1 and 4).
10. Install the collector heat shield (D674HB) onto the header by sliding it on from the rear (Figure 5). while engaging the alignment clips of the collector heat shield with the 2-1/2" heat

shields. Secure with #36 Hose clamp (supplied). NOTE: Do not force heat shield on from the side as this may result in damage to the collector.

11. Slip the muffler cone heat shield (D675HB) from front to back onto the muffler body (D309RB) and secure with #36 hose clamp. (Figure 4) NOTE: Use a low tack painters tape or equivalent to protect the transition between the 4.0" section of muffler body and the inlet cone.
12. Tighten the exhaust system nut, bolts and clamps in the following sequence: (1) Head flange nuts (x4), (3) Muffler body and header 5/16" flange head bolts, (6) Torca band clamp, (2) Front and rear 2-1/8 heat shield hose clamps, (4) Front and rear 2-1/2" heat shield hose clamps, (5) Set location and tighten the collector heat shield hose clamp.
13. Tighten muffler cone heat shield and leave about 1/16" even gap between heat shield and muffler body (Figure 4). NOTE: Make sure the top edge of the heat shield is aligned with the centerline of muffler body to maintain acceptable clearance.
14. Feed wire for the rear O2 sensor around the frame and under the seat. Plug the sensor into the stock wiring connector. For **2006 to 2011 Models** feed connector for the front oxygen sensor around the frame and into the holder on the frame behind rectifier. Plug the sensor into the stock wiring connector. For **2012 to 2013 Models** feed the connector for the front oxygen sensor (Gray) around the frame and into the holder on the frame below rectifier, plug the sensor into the stock wiring connector. NOTE: If the sensor leads are short then order the extensions required for your installation
15. Be sure to tighten all hardware before starting your motorcycle.
16. After installation and before starting motorcycle, remove protective tape and completely clean pipes and mufflers with cleaning solvent and a clean soft cloth that will not leave a residue. NOTE: Any residue or fingerprints will stain the pipes when the metal heats up.

EXHAUST CARE - HELPFUL HINTS TO AVOID DISCOLORATION OF EXHAUST SYSTEM

1. When installing new set of stainless pipes, make sure your hands are clean and free of oil. After installation, thoroughly clean pipes with a soft cloth and cleaning solvent that will leave no residue (acetone, glass cleaner, alcohol, etc...) before starting the motorcycle.
2. It is considered normal for Stainless Steel exhaust systems to discolor due to heat.
3. High performance engine tuning utilizing a dyno will likely result in severe discoloration.
4. Avoid long periods of idling as this can cause discoloration. Intake leaks can cause the engine to run lean and overheat, this could lead to discoloration.
5. Make sure there are no exhaust leaks at the junction of the exhaust pipes and cylinder head. We recommend replacing gaskets if they are worn.

VANCE & HINES OPTIONAL ACCESSORIES

FUELPAK



FUEL MANAGEMENT:

Take the guess work out of fuel injection with Fuelpak Fuel Management, P/N 61005. Contact your local dealer or call (562) 921-0071 to order. Visit fuelpakfi.com for more information.

Fuelpak is intended for racing or off-highway use only, and is not legal for sale or use in California on pollution-controlled vehicles.

O2 Lead Extension

O2 Lead Extensions P/N 71001 are available for this system. These lead extensions allow the user to lengthen the existing leads of the stock 18mm O2 sensors to ease the installation of O2 sensors. Contact your local dealer to order.

PLEASE NOTE: Every effort is made for Vance & Hines Exhaust Systems to provide improved cornering clearance. However, due to design and space limitations on some motorcycle models, ground and cornering clearance may not be improved and in some cases may be reduced. Be sure to follow proper installation instructions.

PACKING LIST

MORE POWER : LESS NOISE

ALL PARTS SHOWN ARE ACTUAL SIZE

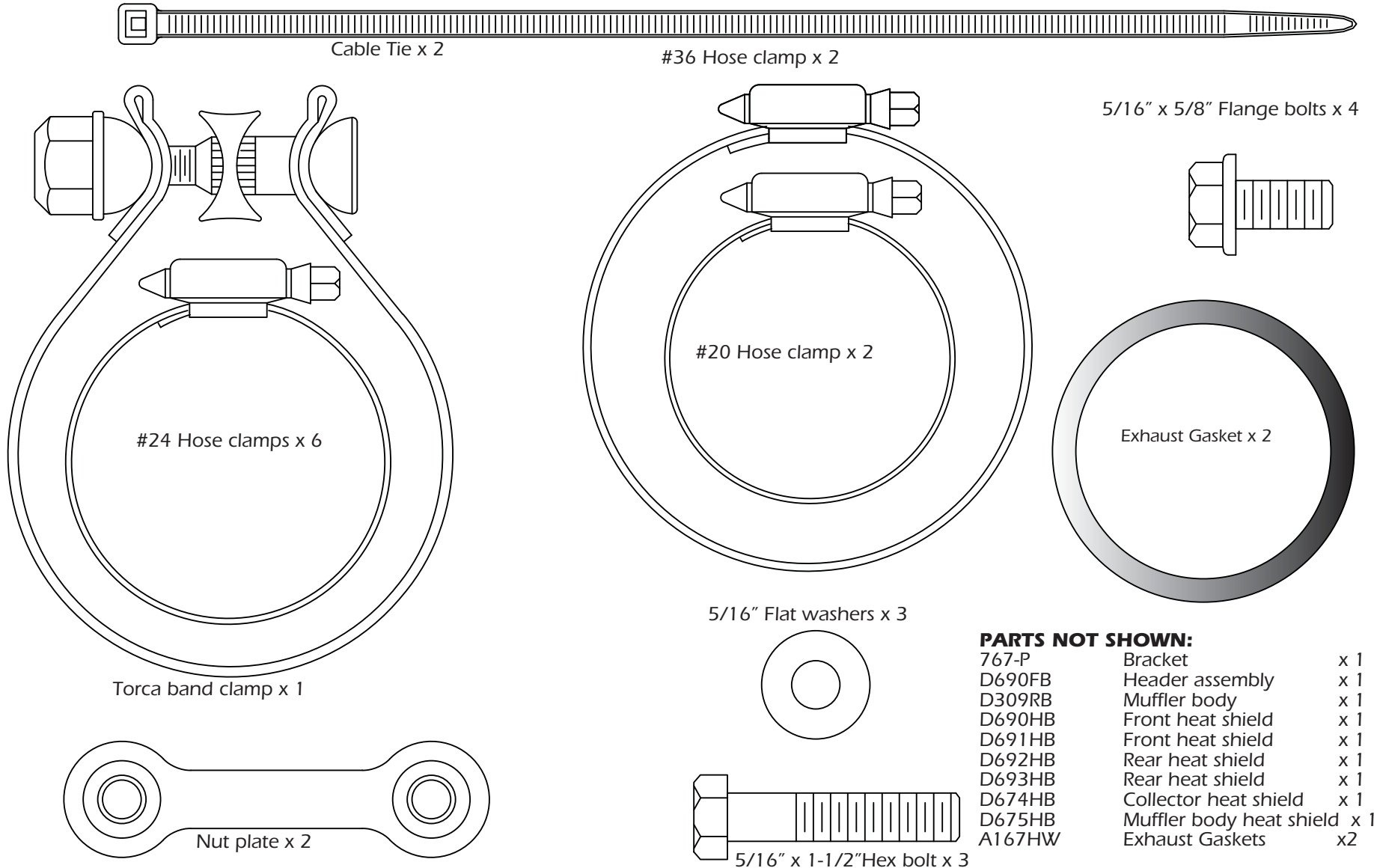

PARTS NOT SHOWN:

| | | |
|--------|--------------------------|-----|
| 767-P | Bracket | x 1 |
| D690FB | Header assembly | x 1 |
| D309RB | Muffler body | x 1 |
| D690HB | Front heat shield | x 1 |
| D691HB | Front heat shield | x 1 |
| D692HB | Rear heat shield | x 1 |
| D693HB | Rear heat shield | x 1 |
| D674HB | Collector heat shield | x 1 |
| D675HB | Muffler body heat shield | x 1 |
| A167HW | Exhaust Gaskets | x2 |

WARRANTY

Vance & Hines exhaust systems are warranted against defects in material and workmanship for a period of 90 days from the date of purchase from an authorized dealer. This warranty does not cover discoloration of chrome finishes. This warranty is limited to the repair or replacement of a product proven to be defective from normal use. Vance & Hines exhaust systems are designed to fit and operate on OEM motor and chassis. This warranty does not cover any product subject to abuse, misuse, improper installation or modification.

FUEL MANAGEMENT

GET THE MOST OUT OF YOUR RIDING EXPERIENCE...

AN AFTERMARKET EXHAUST SYSTEM IS ONLY YOUR FIRST STEP, NOW YOU NEED FUEL MANAGEMENT.

NOW YOU NEED FUELPAK.

Your fuel injected Harley-Davidson® is equipped with an ECU (electronic control unit) that's programmed to deliver fuel to the motor based on an air/fuel ratio for a stock air filter and stock exhaust system. When you install a performance exhaust system, your airflow changes, so you need a fuel management system that adjusts your air/fuel ratio to match the changes. That fuel management system is Fuelpak. Fuelpak adds and takes away fuel, allowing for a more precise range of refinement in your air/fuel ratio. Get the perfect fuel management combination with your Vance & Hines exhaust system, get Fuelpak. For more information visit the tuning center at fuelpakfi.com

NOTICE: Fuelpak is intended for racing or off-highway use only, and is not legal for sale or use in California on pollution-controlled vehicles.



MORE POWER : LESS NOISE

13861 ROSECRANS AVENUE / SANTA FE SPRINGS, CA 90670
SALES: (562) 921-7461 / TECHNICAL: (562) 926-5291 / FAX: (562) 802-0110
VANCEANDHINES.COM